

See this layout and PHOTOS on the web

[www.bullrunwallst.com](http://www.bullrunwallst.com)

Phone: 212-859-2200



Restaurant & Conference Center

**Conference Center Meeting Space**

Four Individual Meeting Rooms.

Interior Walls Can Be Opened

To Create One Large Ballroom.

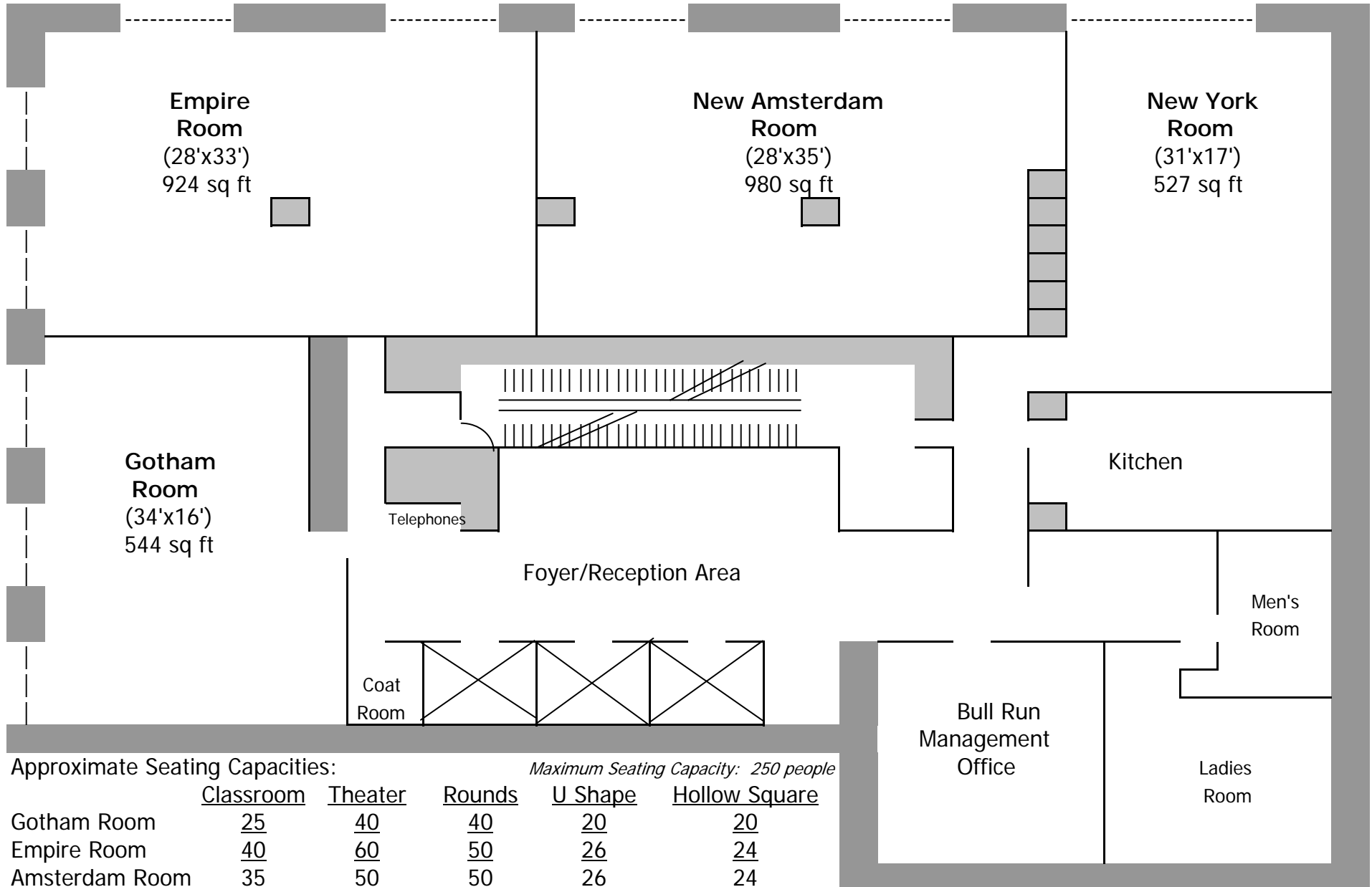

Approximate Seating Capacities:

Maximum Seating Capacity: 250 people

	Classroom	Theater	Rounds	U Shape	Hollow Square
Gotham Room	<u>25</u>	<u>40</u>	<u>40</u>	<u>20</u>	<u>20</u>
Empire Room	<u>40</u>	<u>60</u>	<u>50</u>	<u>26</u>	<u>24</u>
Amsterdam Room	<u>35</u>	<u>50</u>	<u>50</u>	<u>26</u>	<u>24</u>
New York Room	<u>20</u>	<u>40</u>	<u>40</u>	<u>20</u>	<u>20</u>

Total Square Footage=2,975 Ceiling Height = 9 feet